

J.C. PAHEL #33 FRO 1/8" I.P.

Flash w/ Ground  
SITE SESSION REC'D DATE FROM TO  
2 057-3 423 2-26-99 11:16 12:08

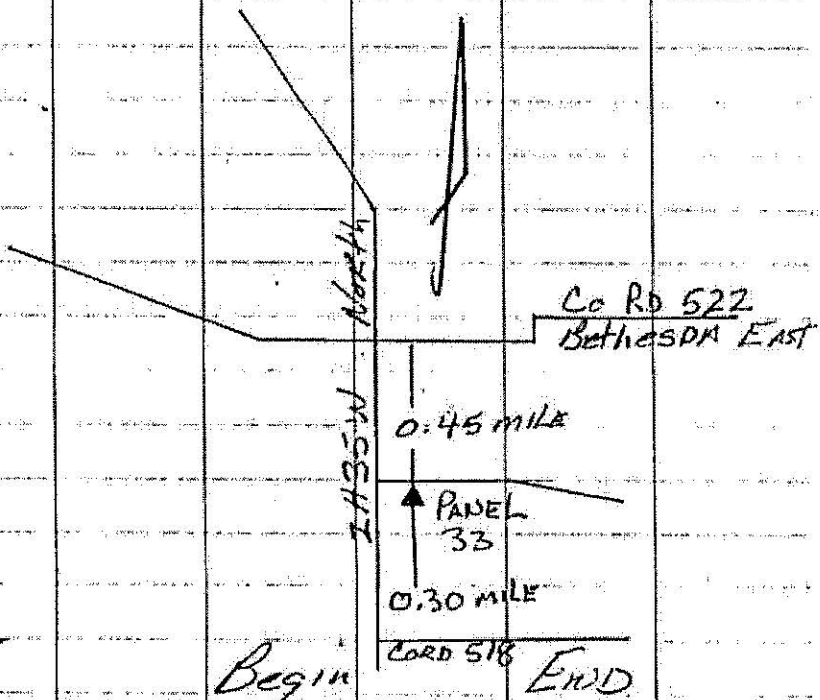

UNIT	BEGIN	END
METERS	1.589	1.589
FEET	5.214	5.214

63

I-495W NORTH

ACCESS RD

